

WG Video over IP

**Videoüberwachung über IT-Netzwerk -
Das Wichtige sehen.**

Die HD-IP-Rekorderserie von WG ist die optimale Lösung für kleine und mittelgroße Anwendungen.

Video over IP ermöglicht die Einbindung von IP-Kameras in bestehende Netzwerke oder die Errichtung eigener IP-Netzwerke speziell für die Videoüberwachung. Dabei streamen die IP-Kameras Bilder in der gewünschten Qualität und Bildrate in das Netzwerk. Der Zugriff ist allen berechtigten Netzwerk-Komponenten möglich. Beispielsweise verarbeitet ein Netzwerkrekorder (NVR) die Bilder und speichert diese auf der Festplatte. Dual Stream Kameras können z.B. einen zweiten Stream mit reduzierter Auflösung bereitstellen, etwa um eine schnelle Bild-Übertragung auch auf Mobilgeräte zu ermöglichen.

Video over IP nutzt eine strukturierte Verkabelung wie jedes moderne IP-Netzwerk. Dadurch ist eine spätere Erweiterung eines Systems sehr effektiv und schnell realisierbar. Die Stromversorgung der Kameras erfolgt in der Regel einfach über das Netzwerkkabel (Power over Ethernet).

Die Vorteile:

- Überwachungsbilder mit überzeugendem Detailreichtum
- Zukunftssicherheit
- Flexibel skalierbar

Sobald ein Gerät in Ihrem IT-Netz eingebunden ist, kann der Zugriff auch per PC, Android oder Apple Endgerät erfolgen.

WG Global GmbH

Sägewerkstraße 3
D- 83416 Surheim

Email: info@wgglobal.eu
D: Tel. +49 8654 7715-0 **Fax:** -29
A: Tel. +43 810 900 313-0 **Fax:** -29

www.wgglobal.de



16- oder 32 Kanal NVR

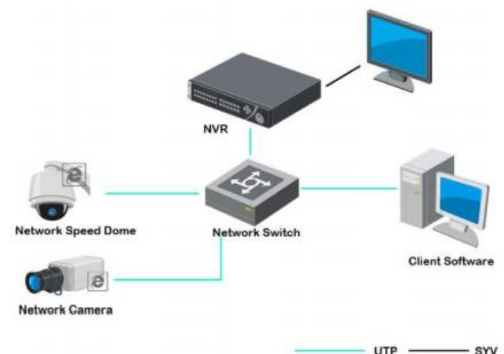

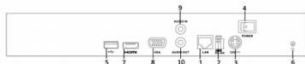

4 bzw. 8 Kanal NVR

REAR PANEL

1. LAN NETWORK INTERFACE
2. RS-485 INTERFACE
3. POWER SUPPLY
4. POWER SWITCH
5. USB INTERFACE
6. GND
7. HDMI INTERFACE
8. VGA OUTPUT
9. AUDIO IN
10. AUDIO OUT

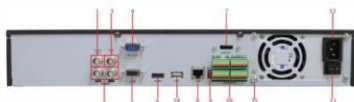

16 bzw. 32 Kanal NVR

REAR PANEL

1. VIDEO OUT
2. CVBS AUDIO OUT AND VGA AUDIO OUT
3. LINE IN
4. RS-232 INTERFACE
5. VGA INTERFACE
6. HDMI INTERFACE
7. ESATA INTERFACE
8. LAN INTERFACE
9. TERMINATION SWITCH
10. RS-485 INTERFACE, CONTROLLER PORT, ALARM IN AND ALARM OUT
11. GROUND
12. AC 100V ~ 240V
13. POWER
14. USB INTERFACE

SPECIFICATION	INVR-04A	INVR-08A
Video/Audio input		
IP video input	4-ch	8-ch
Two-way audio	1-ch, BNC (2.0 Vp-p, 1kΩ)	
Network		
Incoming bandwidth	20Mbps	40Mbps
Output bandwidth	40Mbps	
Remote connection	128	
Video/Audio output		
Output resolution	5MP/3MP/1080p/UXGA/720p/VGA/4CIF/DCIF/2CIF/CIF/QCIF	
HDMI/VGA output	1-ch, resolution: 1920 × 1080P /60Hz, 1600 × 1200 /60Hz, 1280 × 1024 /60Hz, 1280 × 720 /60Hz, 1024 × 768 /60Hz	
CVBS output	1-ch, BNC (1.0 Vp-p, 75 Ω) Resolution: 704 × 576 (PAL); 704 × 480 (NTSC)	
Audio output	1-ch, RCA (Linear, 1kΩ).	
Playback resolution	5MP /3MP /1080P /UXGA /720P /VGA /4CIF /DCIF /2CIF /CIF /QCIF	
Synchronous playback	4-ch, 720P / 2-ch, 1080P / 1-ch, 5MP	8-ch 4CIF /4-ch, 720P / 2-ch, 1080P / 1-ch, 5MP
Hard disk		
SATA	1 SATA interface for 1 HDD	2 SATA interfaces for 2 HDDs
Capacity	Up to 4TB for each disk	
External interface		
Network interface	1 RJ-45 10 /100 /1000 Mbps self-adaptive Ethernet interface	
Serial interface	1 RS-485 half-duplex interface	
USB interface	2 × USB 2.0	
Alarm in	4	
Alarm out	1	
Others		
Power supply	12V DC	
Consumption (without hard disk or DVD-R/W)	≤ 10 W	
Working temperature	-10 °C ~ +55 °C (14 °F ~ 131 °F)	
Working humidity	10%~90%	
Chassis	Stand-alone 1U chassis	19-inch rack-mounted 1U chassis
Dimensions (W × D × H)	315 × 230 × 45mm	445 × 290 × 45mm
Weight	≤ 2 Kg (without hard disk)	

SPECIFICATION	INVR-16A	INVR-32A
Video/Audio input		
IP video input	16-ch	32-ch
Two-way audio	1-ch, BNC (2.0 Vp-p, 1kΩ)	
Video/Audio output		
Recording resolution	5MP /3MP /1080P /UXGA /720P /VGA /4CIF /DCIF /2CIF /CIF /QCIF	
Frame rate	Main stream: 25 fps (P) / 30 fps (N) Sub-stream: 25 fps (P) / 30 fps (N)	
CVBS output	1-ch, BNC (1.0 Vp-p, 75 Ω) Resolution: 704 × 576 (PAL); 704 × 480 (NTSC)	
HDMI output	1-ch, resolution: 1920 × 1080P /60Hz, 1920 × 1080P /50Hz, 1600 × 1200 /60Hz, 1280 × 1024 /60Hz, 1280 × 720 /60Hz, 1024 × 768 /60Hz	
VGA output	1-ch, resolution: 1920 × 1080P /60Hz, 1600 × 1200 /60Hz, 1280 × 1024 /60Hz, 1280 × 720 /60Hz, 1024 × 768 /60Hz	
Audio output	2-ch, BNC (Linear, 600Ω)	
Playback resolution	5MP /3MP /1080P /UXGA /720P /VGA /4CIF /DCIF /2CIF /CIF /QCIF	
Synchronous playback	16-ch	16-ch
Hard disk		
SATA	4 SATA interfaces for 2 HDDs + 1 DVD-R/W (default), or 4HDDs	
eSATA	1 eSATA interface	
Capacity	Up to 4TB capacity for each HDD	
External interface		
Network interface	1 RJ-45 10 /100 /1000 Mbps self-adaptive Ethernet interface	
Serial interface	RS-232; RS-485; Keyboard	
USB interface	3 × USB 2.0	
Alarm in	16	
Alarm out	4	
Others		
Power supply	100 ~ 240 VAC, 6.3 A, 50 ~ 60 Hz	
Consumption (without hard disk or DVD-R/W)	≤ 40 W	≤ 45 W
Working temperature	-10 °C ~ +55 °C (14 °F ~ 131 °F)	
Working humidity	10%~90%	
Chassis	19-inch rack-mounted 2U chassis	
Dimensions (W × D × H)	445 × 390 × 90 mm	
Weight	≤ 4 Kg (8.82 lb) (without hard disk or DVD-R/W)	

WG Global GmbH

Sägewerkstraße 3

D- 83416 Surheim

Email: info@wgglobal.eu

D: Tel. +49 8654 7715-0 **Fax:** -29

A: Tel. +43 810 900 313-0 **Fax:** -29

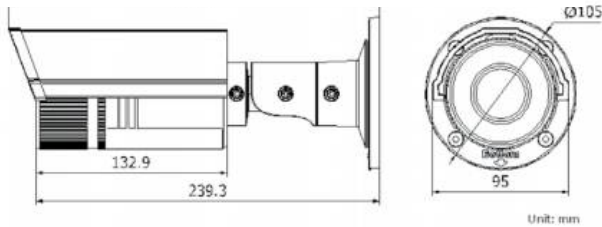

PARAMETER	IWH-33VR / 33VR2
Camera	
Image Sensor	1/3" Progressive Scan CMOS
Min. Illumination	0.07 Lux @ (F1.2, AGC ON), 0 Lux with IR
Shutter speed	1/25 s to 1/100,000 s
Lens	2.8 - 12 mm @ F1.4, Angle of view: 98°-30.5°
Lens Mount	M12
Day & Night	IR cut filter with auto switch
Digital Noise Reduction	3D DNR
Wide Dynamic Range	Digital WDR
Compression Standard	
Video Compression	H.264/MJPEG
Video Bit Rate	32 Kbps - 16 Mbps
Dual Stream	Yes
Image	
Max. Resolution	2048 x 1536
Frame Rate	50 Hz: 12.5fps (2048 x 1536), 25fps (1920 x 1080), 25fps (1280 x 720) 60 Hz: 15fps (2048 x 1536), 30fps (1920 x 1080), 30fps (1280 x 720)
Image Settings	Saturation, Brightness, Contrast adjustable by client software or web browser
Backlight compensation	Yes, zone optional
Network	
Network Storage	NAS (iSCSI optional)
Alarm Trigger	Motion detection, Tampering alarm
Protocols	TCP/IP, HTTP, DHCP, DNS, DDNS, RTP, RTSP, PPPoE, SMTP, NTP, UPnP, ICMP, IGMP, SNMP, FTP, 802.1X, QoS, HTTPS (SIP, SRTP, IPv6 optional)
Security	User Authentication, Watermark
Standard	ONVIF, PSIA, CGI
Interface	
Communication Interface	1 RJ45 10M/100M Ethernet interface
On-board storage	Built-in SD/SDHC slot, up to 32 GB
General	
Operating Conditions	-30 °C - 60 °C (-22 °F - 140 °F) Humidity 95% or less (non-condensing)
Power Supply	12 V DC ± 10% / PoE (802.3af)
Power Consumption	Max. 5 W (Max. 7 W with IR cut filter on)
Ingress Protection level	IP66
EXIR Range	Approx. 30 meters
Dimensions	98x88.6x258.6 mm (3.9" x 3.5" x 10.2")
Weight	

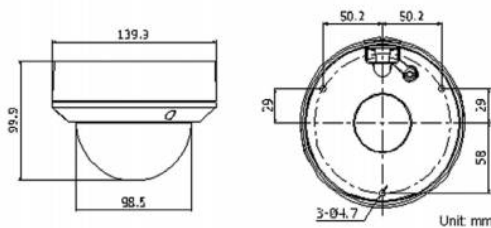

SPECIFICATION	IDH-23VR	IDH-33VR
Camera		
Image Sensor	1/3" Progressive Scan CMOS	
Min. Illumination	0.07 Lux @ (F1.2, AGC ON), 0 Lux with IR	
Shutter speed	1/25 s to 1/100,000 s	
Lens	2.8 - 12 mm @ F1.4, Angle of view: 98°-30.5°	
Day & Night	IR cut filter with auto switch	
Digital Noise Reduction	3D DNR	
Wide Dynamic Range	Digital WDR	
Compression Standard		
Video Compression	H.264/MJPEG	
Video Bit Rate	32 Kbps - 16 Mbps	
Dual Stream	Yes	
Image		
Max. Resolution	1920 * 1080	2048 x 1536
Frame Rate	25fps@1080P	12.5fps@3M, 25fps@1080P
Image Settings	Saturation, Brightness, Contrast adjustable by client software or web browser	
Backlight compensation	Yes, zone optional	
Network		
Alarm Trigger	Motion detection, Tampering alarm	
Protocols	TCP/IP, HTTP, DHCP, DNS, DDNS, RTP, RTSP, PPPoE, SMTP, NTP, UPnP, ICMP, IGMP, SNMP, FTP, 802.1X, QoS, HTTPS (SIP, SRTP, IPv6 optional)	
Security	User Authentication, Watermark	
Standard	ONVIF, PSIA, CGI	
Interface		
Communication Interface	1 RJ45 10M/100M Ethernet interface	
On-board storage	Built-in Micro SD card slot, up to 32 GB	
General		
Operating Conditions	-30 °C - 60 °C (-22 °F - 140 °F) Humidity 95% or less (non-condensing)	
Power Supply	12 V DC ± 10% / PoE (802.3af)	
Power Consumption	Max. 5 W	
Ingress Protection level	IP66	
Impact Protection	IEC60068-275Eh, 50J; EN50102, up to IK10	
IR Range	Approx. 20 meters	
OSD Language	Bulgarian, Czech, Dutch, English, French, German, Greek, Hungarian, Italian, Polish, Portuguese, Russian, Slovak, Spanish, Turkish	
Dimensions	Ø 140 x 99.9 mm (Ø 5.51" x 3.94")	
Weight	1kg (2.2 lbs)	

WG Global GmbH

Sägewerkstraße 3
D- 83416 Surheim

Email: info@wgglobal.eu
D: Tel. +49 8654 7715-0 **Fax:** -29
A: Tel. +43 810 900 313-0 **Fax:** -29

www.wgglobal.de



Pendant Mount Aluminium Bracket



Wall Mount Aluminium Bracket with gang box

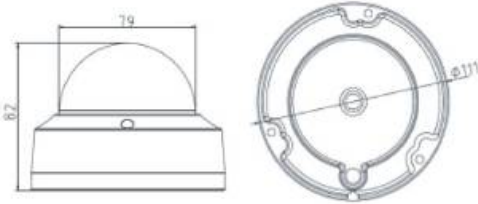

SPECIFICATION	IDH-11IR	IDH-21IR	IDH-31IR
Camera			
Image Sensor	1/3" Progressive Scan CMOS		
Min. Illumination	0.07 Lux @ (F1.2, AGC ON), 0 Lux with IR		
Shutter speed	1/25 s to 1/100,000 s		
Lens	2.8mm@F2.0, Angle of view: 75.8° (4mm, 6mm, 12mm optional)		
Day & Night	IR cut filter with auto switch		
Digital Noise Reduction	3D DNR		
Wide Dynamic Range	Digital WDR		
Angle Adjustment	Pan:0° - 355°, Tilt: 0° - 65°		
Compression Standard			
Video Compression	H.264/MJPEG		
H.264 Type	Main Profile		
Video Bit Rate	32 Kbps - 16 Mbps		
Dual Stream	Yes		
Image			
Max. Resolution	1280 * 960	1920 * 1080	2048 x 1536
Frame Rate	25fps@1280*960	25fps@1080P	12.5fps@3M, 25fps@1080P
Image Settings	Saturation, Brightness, Contrast adjustable by client software or web browser		
Backlight compensation	Yes, zone optional		
Network			
Alarm Trigger	Motion detection, Tampering alarm		
Protocols	TCP/IP, HTTP, DHCP, DNS, DDNS, RTP, RTSP, PPPoE, SMTP, NTP, UPnP, ICMP, IGMP, SNMP, FTP, 802.1X, QoS, HTTPS (SIP, SRTP, IPv6 optional)		
Security	User Authentication, Watermark		
Standard	ONVIF, PSIA, CGI		
Interface			
Communication Interface	1 RJ45 10M/100M Ethernet interface		
General			
Operating Conditions	-30 °C - 60 °C (-22 °F - 140 °F) Humidity 95% or less (non-condensing)		
Power Supply	12 V DC ± 10% / PoE (802.3af)		
Power Consumption	Max. 5 W (Max. 7 W with IR cut filter on)		
Ingress Protection level	IP66		
IR Range	Approx. 20 to 30 meters		
Impact Protection	IEC60068-2-75EH, 50J; EN50102, up to 1K10		
OSD Language	Bulgarian, Czech, Dutch, English, French, German, Greek, Hungarian, Italian, Polish, Portuguese, Russian, Slovak, Spanish, Turkish		
Dimensions	Ø111 × 82 (4.4" × 3.2")		
Weight	500g (1.1 lbs)		

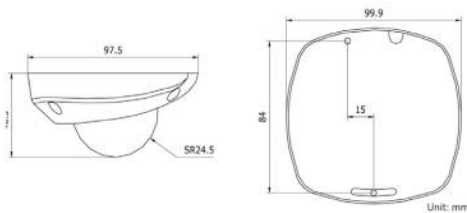

SPECIFICATION	IMH-21
Camera	
Image Sensor	1/3" Progressive Scan CMOS
Min. Illumination	0.5 Lux @ (F1.2, AGC ON), 0.1 Lux @ (F1.2, AGC ON, sensitivity × 5) 1.1 Lux @ (F1.8, AGC ON), 0.2 Lux @ (F1.8, AGC ON, sensitivity × 5)
Shutter speed	1/25 s to 1/100,000 s
Lens	2.8mm@F1.8 (4mm, 6mm, 8mm optional), Angle of view: 75.8°
Angle Adjustment	Pan: ± 15°, Tilt: 0 - 90°, Rotation: ± 15°
Day & Night	Electronic
Compression Standard	
Video Compression	H.264/MPEG4/MJPEG
Video Bit Rate	32 Kbps - 16 Mbps
Dual Stream	Yes
Image	
Max. Resolution	1600 x 1200
Frame Rate	50 Hz: 12.5 fps (1600 × 1200), 12.5 fps (1600 × 912), 25 fps (1280 × 960), 25 fps (1280 × 720)
Image Settings	Saturation, Brightness, Contrast adjustable by client software or web browser
Picture Overlay	LOGO picture can be overlaid on video
Network	
Alarm Trigger	Motion detection, Dynamic Analysis, Tampering alarm
Protocols	TCP/IP, HTTP, DHCP, DNS, DDNS, RTP, RTSP, PPPoE, SMTP, NTP, UPnP, ICMP, IGMP, SNMP, FTP, 802.1X, QoS, HTTPS (SIP, SRTP, IPv6 optional)
Security	User Authentication, Watermark, IP address filtering, anonymous access
Standard	ONVIF, PSIA, CGI
Interface	
Communication Interface	1 RJ45 10M/100M Ethernet interface
Reset Button	Yes
General	
Operating Conditions	-10 °C - 60 °C (14 °F - 140 °F) Humidity 90% or less (non-condensing)
Power Supply	12 V DC ± 10% / PoE (802.3af)

WG Global GmbH

Sägewerkstraße 3
D- 83416 Surheim

Email: info@wgglobal.eu
D: Tel. +49 8654 7715-0 **Fax:** -29
A: Tel. +43 810 900 313-0 **Fax:** -29

www.wgglobal.de